

9. Appendices

APPENDIX A – LOCATION PLAN

202000

204000

206000

316000

318000

320000

322000

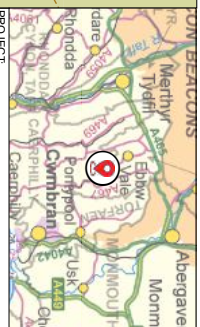
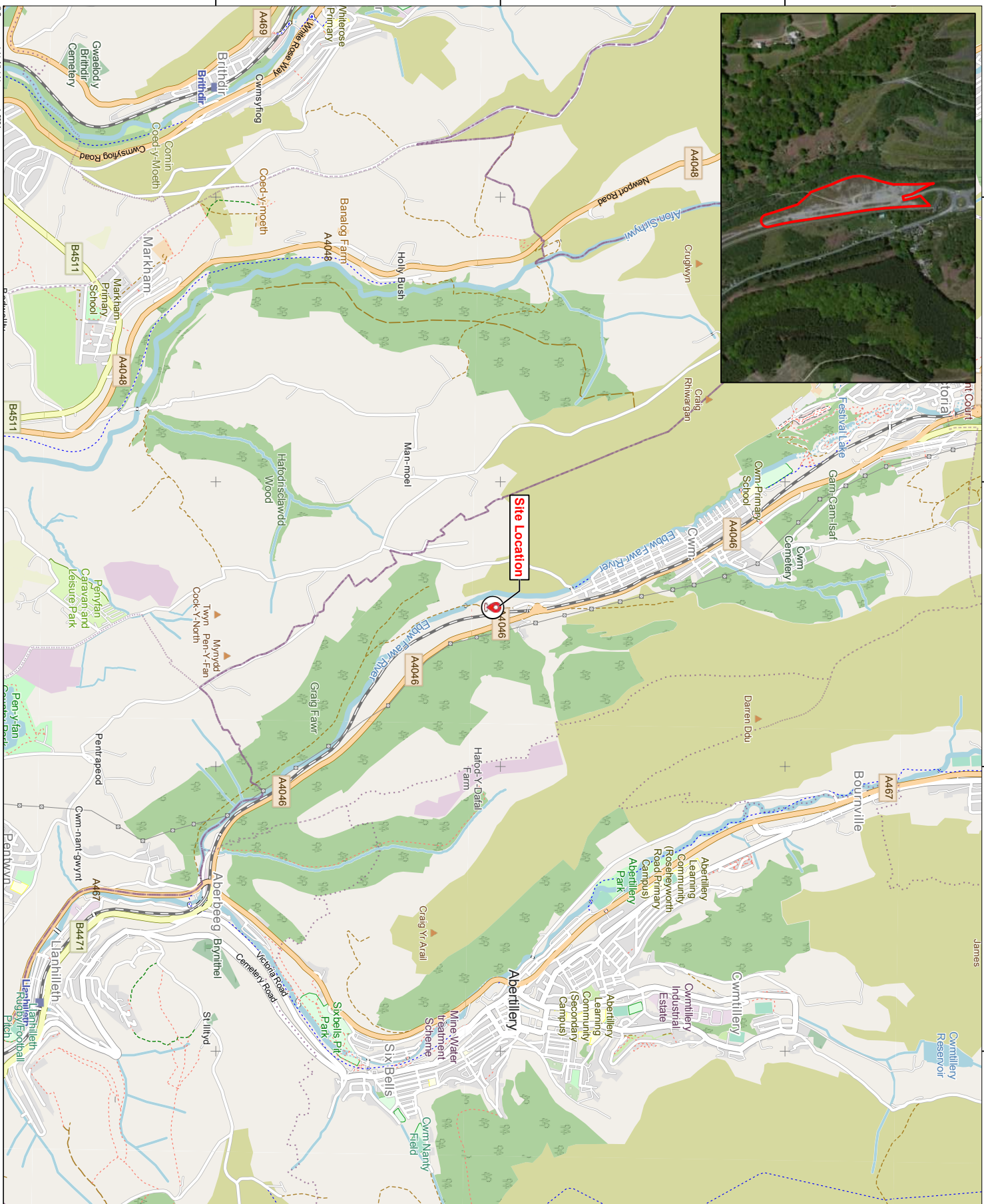

PROJECT:
Cwm Marine Colliery,
Ebbw Vale, NP23 7TL

TITLE:
Regional Plan

- Legend:
- Site Location
 - Indicative Site Boundary



Capital Transport Planning
Email: info@capitalp.co.uk

| Rev | Date | Purpose of Revision | Drawn |
|-----|------------|---------------------|-------|
| A | 07/04/2021 | Initial Issue | DR |

Drawing Reference:
702345



SCALE: 1:25,000



ISO A3
DO NOT SCALE

© Crown copyright. All rights reserved. 2021
World Imagery, Contour, Source: Esri, DigitalGlobe, GeoEye, Earthstar Geographics, CNES/Airbus DS, USDA, USGS, AeroGRID, IGN, and the GIS User Community
OpenStreetMap, Map data © OpenStreetMap contributors, Also OpenStreetMap contributors, Also OpenStreetMap contributors, Also OpenStreetMap contributors
This plan is provided for illustrative purposes only and does not constitute an offer of any services or products for any decisions made from this drawing.

APPENDIX B – SITE LAYOUT PLAN

SCHEDULE OF ACCOMMODATION

- 1 Welfare facility (228 sq m)
- 2 Artworks (152sq m)
- 3 Catering / Cleaning Storage (170sq m)
- 4 S.O.D workshop / welfare (145sq m)
- 5 Main area parking capacity (262 sq m)
- 6 Garage repair facility (183 sq m inc HDV Bay)
- 7 HDV area through (area incorporated in 7)
- 8 External parking area (1672 sq m)
- 9a Welfare office
- 9b Internal open storage
- 10 Possible external external plant area / Battery Store(183 sq m)
- 11 External vehicle wash down ramp (facility to clean underside) - enclosed spray housing (172 sq m approx)
- 12 Service vehicle park area
- 13 Protection area to avoid clashes with building
- 14 Plant area including various fuel type / internal card reader system CCTV
- 15 Electric meter cover area with raised area for draining roof - enclosed spray housing (174 sq m) 15 x 12m platform inc raised area and steps
- 16 External storage and washing / enclosed double sided free vehicle storage rack / fenced
- 18 Building material pick up zone inc bays and vehicle access area (3 x 5m open bays) (202 sq m)
- 19a Service store
- 19b Main fuel for service store
- 17a External sewer store (24 sq m)
- 18a External inc open water (110 sq m)
- 19 Potential turning circle if required
- 20 Potential future expansion
- 21 Recycling vehicle bays 27m x (8 x 3.5m bay) electric hook up
- 22 Large trailer / vehicle collection bays 12m x 3.5m bay electric hook up
- 23 3m bay electric hook up
- 24 2.7 m bay electric hook up
- 25 Large area 42m x (8 x 3m bay) electric hook up
- 26 Small area 20m x (8 x 3.5m bay) electric hook up
- 27 Potential alternative storage area / Release area / open water (1022 sq m)
- 28 Existing fire shaft / Catering loading offload and back wall / refurbish over shaft
- 29 Existing fire shaft
- 30 Garage Repair Facility entrance external bays / vehicle waiting
- 31 General parking / waiting
- 32 General large vehicle parking / waiting
- 33 Existing cycle inside vehicle boundary
- 34 Existing river outside boundary
- 35 Road crossing point
- 36 Staff parking electric charging zone/ 50 spaces
- 37 Staff / vehicle parking / cycle store / accessible parking 57 spaces (11m electric charged access bay)
- 38 Central Depot main office (275 sq m)
- 39 Potential Development Plot / Equipment (2047 sq m) Potential Development Plot / Equipment (2047 sq m)
- 40 Central Depot main entrance (access control)
- 41 Main highway vehicle slip boundary
- 42 Access roundabout
- 43 Catering
- 44 Existing Central Depot welfare facility (188 sq m)
- 45 Existing Central Depot general store (inc S.O.D) Catering and cleaning/ foot print (1458 sq m)
- 46 Existing Central Depot general store facility foot print (268 sq m)
- 47 Existing Central Depot internal parking / Welfare facility foot print (1485 sq m)
- 48 Existing Container (275' x 125' x 105' high) each measuring 33 cubic metres
- 49 50m Store (270 sq m)
- 50 Existing Central Depot office facility (208 sq m)
- 51 Cycle Compound
- 52 Site
- 53 Access Control barrier - TAG system

KEY - UTILISATION

| Color | Description |
|-------------|-----------------------|
| Blue | Office / Admin |
| Orange | Workshop / Storage |
| Green | Parking / Access |
| Yellow | Service / Maintenance |
| Purple | Welfare / Amenities |
| Pink | Specialized Storage |
| Light Green | General Parking |

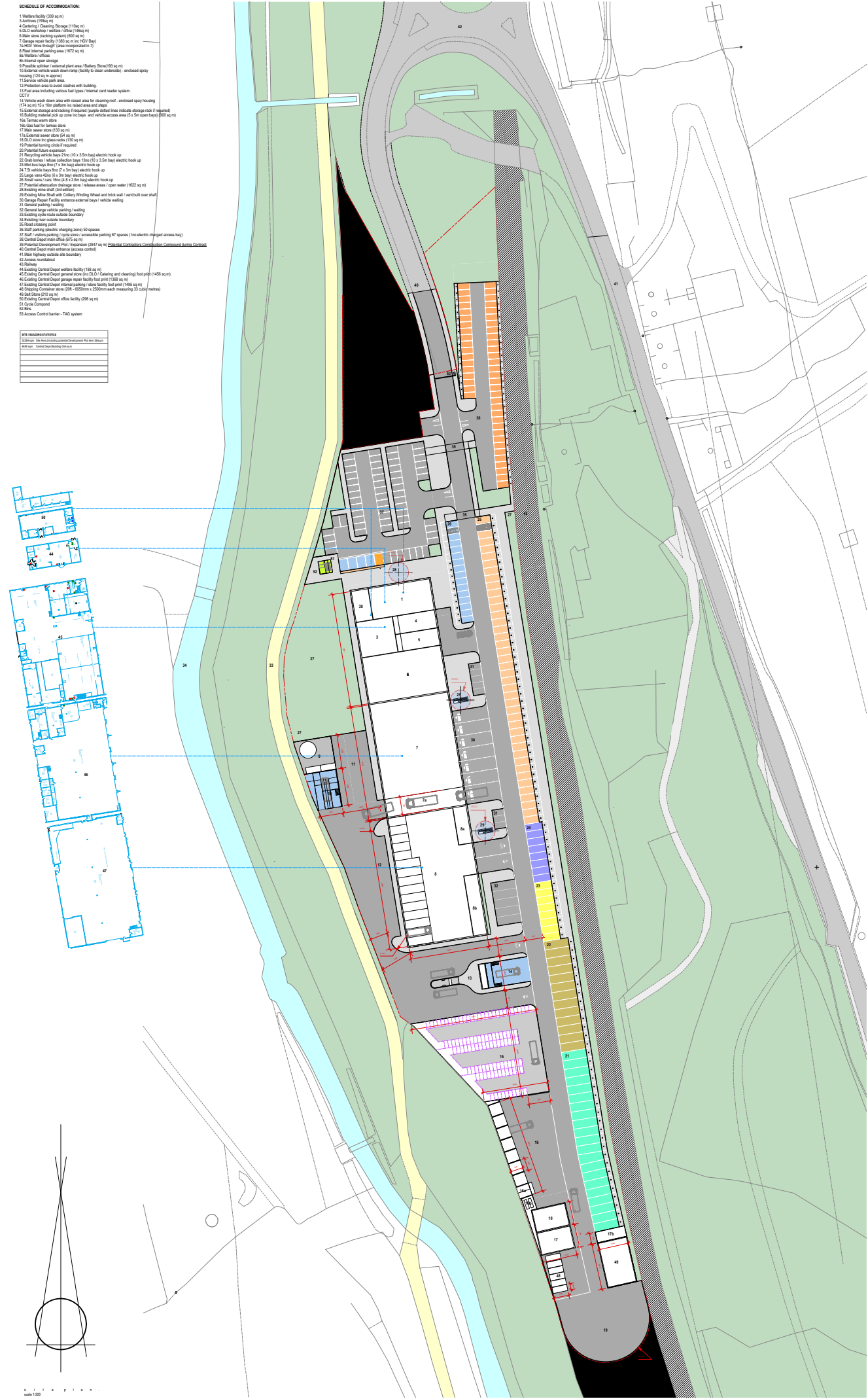

scale 1:500



APPENDIX C – PROPOSED FOOTWAY

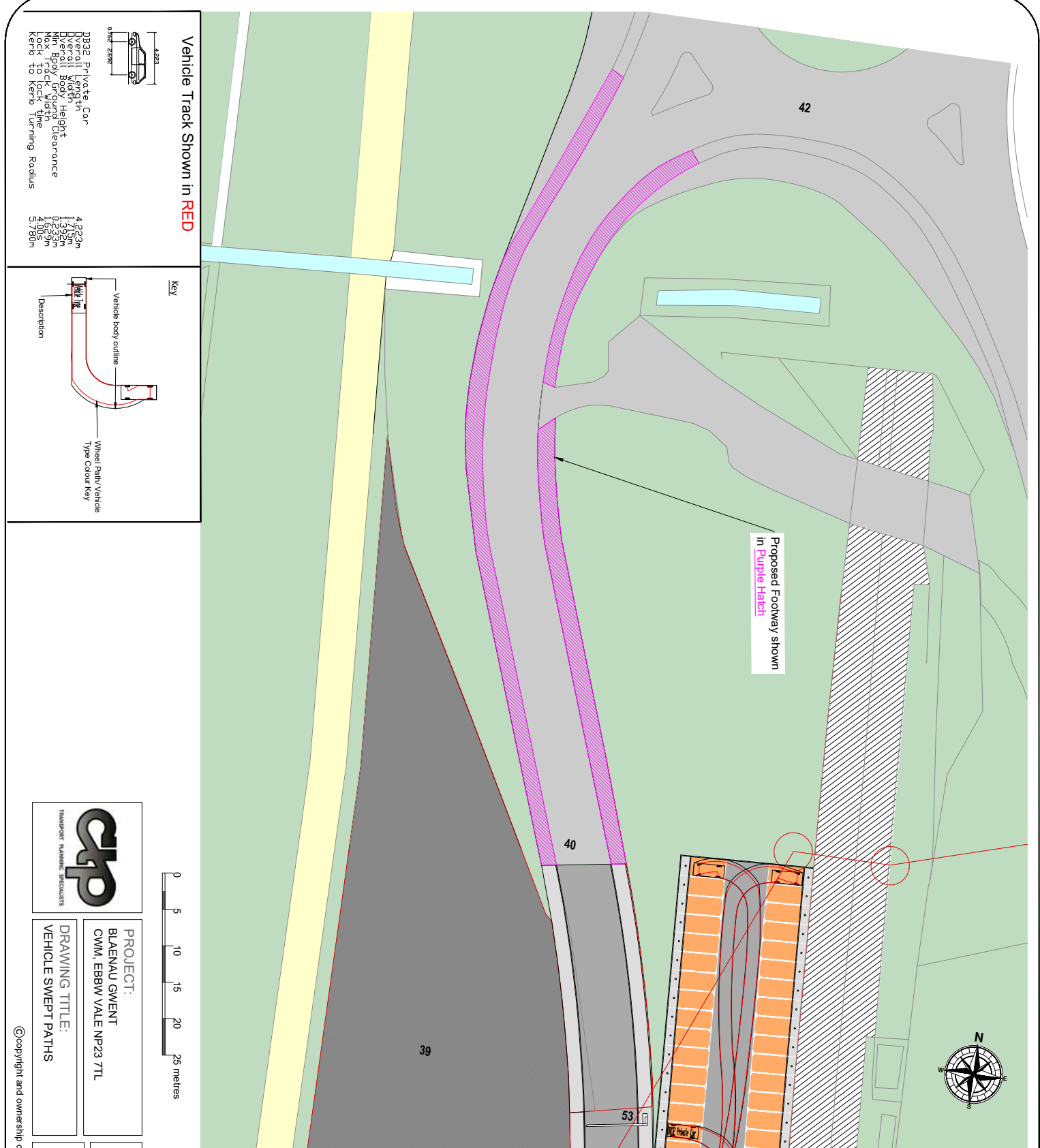

Proposed Footway shown in Purple Hatch

Vehicle Track Shown in RED

| | |
|-----------------------------|--------|
| D392 Private Car | 4.233m |
| Overall Width | 1.715m |
| Overall Body Height | 1.332m |
| Max Body Clearance | 1.629m |
| Lock to lock width | 4.015m |
| Lock to kerb turning Radius | 5.750m |

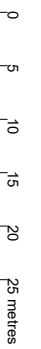
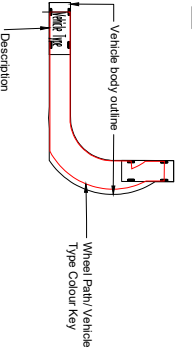

PROJECT:
BLAENAU GWENT
CWM, EBBW VALE NP23 7TL

DRAWING TITLE:
VEHICLE SWEEP PATHS

DRAWN BY:
SC

DATE:
APR 2021

SCALE:
1:500 @ A3

DRAWING No: 170443 / VS01

SHEET: 1 of 4

REVISION:

SCHEDULE OF ACCOMMODATION:

- 1 Welfare facility (739 sq m)
- 3 Archives (151sq m)
- 4 Catering / Cleaning Storage (1119sq m)
- 5 DLO workshop / welfare / office (146sq m)
- 6 Main store (loading system) (800 sq m)
- 7 Garage repair facility (1383 sq m inc HGV Bay)
- 7a HGV 'drive through' area incorporated in 7)
- 8 Fuel internal parking area (1672 sq m)
- 8a Welfare / offices
- 8b Internal open storage
- 9 Possible splinker / external plant area / Battery Store (193 sq m)
- 10 External vehicle wash down ramp (facility to clean underside) - enclosed spray housing (120 sq m approx)
- 11 Sports vehicle park area
- 12 Protection area to avoid clashes with building
- 13 Fuel area including various fuel types / internal card reader system, CCTV
- 14 Vehicle wash down area with raised area for cleaning roof - enclosed spray housing (174 sq m) 15 x 10m platform inc raised area and steps
- 15 External storage and racking (if required) (purple dotted lines indicate storage rack if required)
- 16 Building material lock up zone inc bags and vehicle access area (5 x 5m open bay) (900 sq m)
- 16a Terrace warm store
- 16b Gas fuel for terrace store
- 17 Main sewer store (130 sq m)
- 17a External sewer store (64 sq m)
- 18 DLO store inc glass racks (130 sq m)
- 19 Potential lighting rack if required
- 20 Potential future
- 21 Receiving vehicle bays 21no (10 x 3.5m bay) electric hook up
- 22 Good store / welfare reception bays 13no (10 x 3.5m bay) electric hook up
- 22A Hub bus bays 7no (7 x 3m bay) electric hook up
- 24 7.5 vehicle bays 6no (7 x 3m bay) electric hook up
- 25 1.8 vehicle bays 6no (3 x 3m bay) electric hook up
- 26 Small vans (cars) 6no (4.8 x 2.0m bay) electric hook up
- 27 Potential alternative / change store / release areas / open water (1622 sq m)
- 28 Existing mine shaft (0m edition)
- 29 Existing mine shaft with Colliery Winding Wheel and brick wall - vent duct over shaft
- 30 Caterer/Repair facility entrance external bays / vehicle waiting
- 32 General parking / waiting
- 32 General large vehicle parking / waiting
- 32 Existing cycle route outside boundary
- 34 Existing over route outside boundary
- 35 Road crossing point
- 36 Staff parking (electric charging zone) 50 spaces
- 37 Staff / visitors parking / cycle store / accessible parking 67 spaces (1no electric charged access bay)
- 38 Central Depot main office (675 sq m)
- 39 Fulmar Development PDI / Expansion (2947 sq m) Potential/Contractors Construction Compound during Contract
- 40 Central Depot entrance (access control)
- 41 Main highway outside site boundary
- 42 Access roundabout
- 43 Railway
- 44 Existing Central Depot welfare facility (188 sq m)
- 45 Existing Central Depot general store (inc DLO / Catering and cleaning) foot print (1456 sq m)
- 46 Existing Central Depot garage repair facility foot print (1388 sq m)
- 47 Existing Central Depot internal parking / store facility foot print (1495 sq m)
- 48 Shipping Container store (20ft - 6050mm x 2300mm each measuring 33 cubic metres)
- 49 3x11 Store (210 sq m)
- 50 Existing Central Depot office facility (299 sq m)
- 51 Cycle Compound
- 52 Bins
- 53 Access Control barrier - TAG system

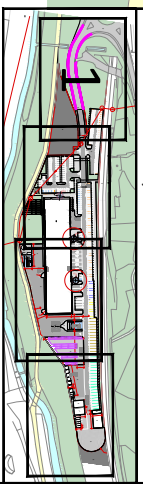

APPENDIX D – SWEPT-PATH ANALYSIS

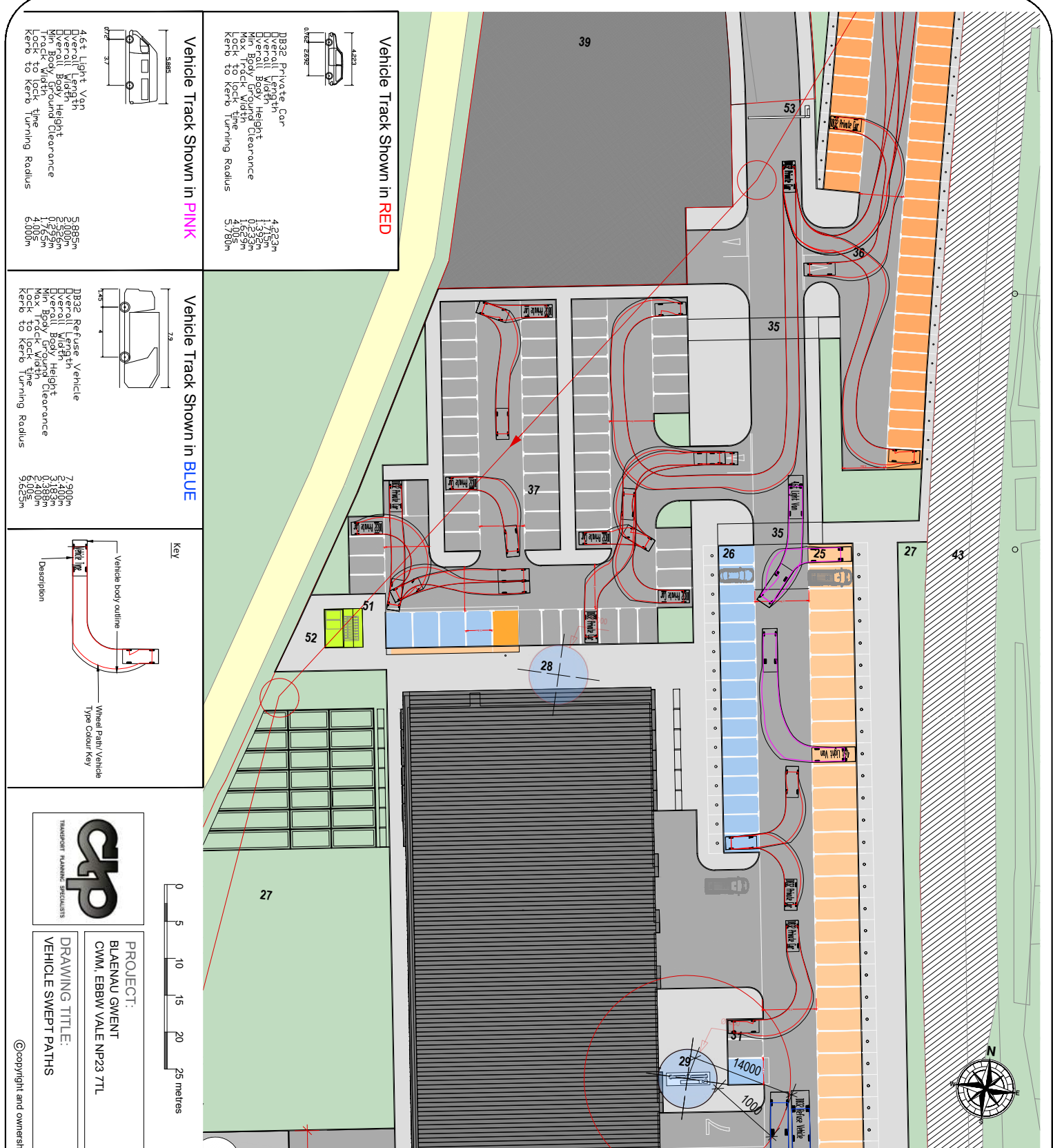

Vehicle Track Shown in RED

| | |
|-----------------------------|--------|
| DB32 Private Car | 4.232m |
| Overall Length | 1.975m |
| Overall Width | 1.332m |
| Overall Body Height | 0.723m |
| Min. Body Ground Clearance | 0.232m |
| Lock to lock time | 4.005s |
| Kerb to Kerb Turning Radius | 5.780m |

Vehicle Track Shown in BLUE

| | |
|-----------------------------|--------|
| DB32 Refuse Vehicle | 7.900m |
| Overall Length | 2.400m |
| Overall Width | 2.183m |
| Overall Body Height | 2.400m |
| Min. Body Ground Clearance | 0.232m |
| Lock to lock time | 2.400m |
| Kerb to Kerb Turning Radius | 9.625m |

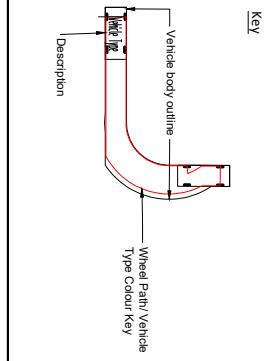

TRANSPORT PLANNING SPECIALISTS

PROJECT:
BLAENAU GWENT
CWM, EBBW VALE NP23 7TL

DRAWING TITLE:
VEHICLE SWEEP PATHS

DATE:
APR 2021

DRAWN BY:
SC

SCALE:
1:500 @ A3

SHEET:
2 of 4

DRAWING No.:
170443 / VS01

REVISION:
-

0 5 10 15 20 25 metres

SCHEDULE OF ACCOMMODATION:

- Welfare facility (139 sq m)
- Archives (158sq m)
- Catering / Cleaning Storage (119sq m)
- DLO workshop / welfare / office (146sq m)
- DLO workshop / welfare / office (146sq m)
- Main store (loading system) (600 sq m)
- Garage repair facility (1383 sq m inc HGV Bay)
- HGV 'drive through' area incorporated in 7)
- Fuel internal parking area (1672 sq m)
- Welfare / offices
- Internal open storage
- Possible splitter / external plant area / Battery Store (193 sq m)
- External vehicle wash down ramp (facility to clean underside) - enclosed spray housing (120 sq m approx)
- Service vehicle park area
- Protection area to avoid clashes with building
- Fuel area including various fuel types / internal card reader system, CCTV
- Vehicle wash down area with raised area for cleaning roof - enclosed spray housing (1174 sq m) 15 x 10m platform inc raised area and steps
- External storage and racking (required) (purple dotted lines indicate storage rack if required)
- Building material pick up zone inc bags and vehicle access area (5 x 5m open bay) (900 sq m)
- Inc. Terrace warm store
- Gas fuel for biomass store
- Main sewer store (130 sq m)
- External sewer store (64 sq m)
- DLO store inc glass necks (130 sq m)
- Potential lunning rack if required
- Potential future
- Recycling vehicle bay 7m x 10 x 3.5m bay/ electric hook up
- Cell bay / refuse collection bay 13m (10 x 3.5m bay) electric hook up
- 22x1m inc bus bay (7 x 3m bay) electric hook up
- 24 x 7.5m vehicle bay (6 x 3m bay) electric hook up
- 26 Store bins (4 x 3m bay) electric hook up
- 27 Potable alternative (drainage store / release areas / open water (1622 sq m)
- 28 Existing mine shaft (3rd edition)
- 29 Existing mine shaft (3rd edition)
- 30 Existing mine shaft (3rd edition)
- 31 Garage/Repair facility entrance external bays / vehicle waiting
- 32 General large vehicle parking / waiting
- 33 Existing cycle route outside boundary
- 34 Existing over route outside boundary
- 35 Store crossing point
- 36 Staff parking (electric charging zone) 50 spaces
- 37 Staff / visitors parking / cycle store / accessible parking 67 spaces (1no electric charged access bay)
- 38 Central Depot main office (675 sq m)
- 39 External Development 'Pod' / Expansion (2947 sq m) Potential/Contractors Construction Contingent during Contract
- 40 Central Depot main entrance (access control)
- 41 Main highway outside site boundary
- 42 Access roundabout
- 43 Railway
- 44 Existing Central Depot welfare facility (188 sq m)
- 45 Existing Central Depot general store (inc DLO) Catering and cleaning food print (1456 sq m)
- 46 Existing Central Depot garage repair facility food print (1388 sq m)
- 47 Existing Central Depot internal parking / store facility food print (1495 sq m)
- 48 Shipping Container store (20ft - 6050mm x 2300mm each measuring 33 cubic metres)
- 49 Sill Store (210 sq m)
- 50 Existing Central Depot office facility (299 sq m)
- 51 Cycle Compont
- 52 Bins
- 53 Access Control barrier - TAG system



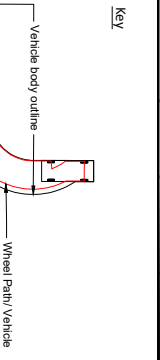
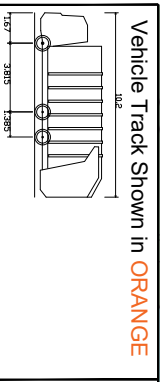
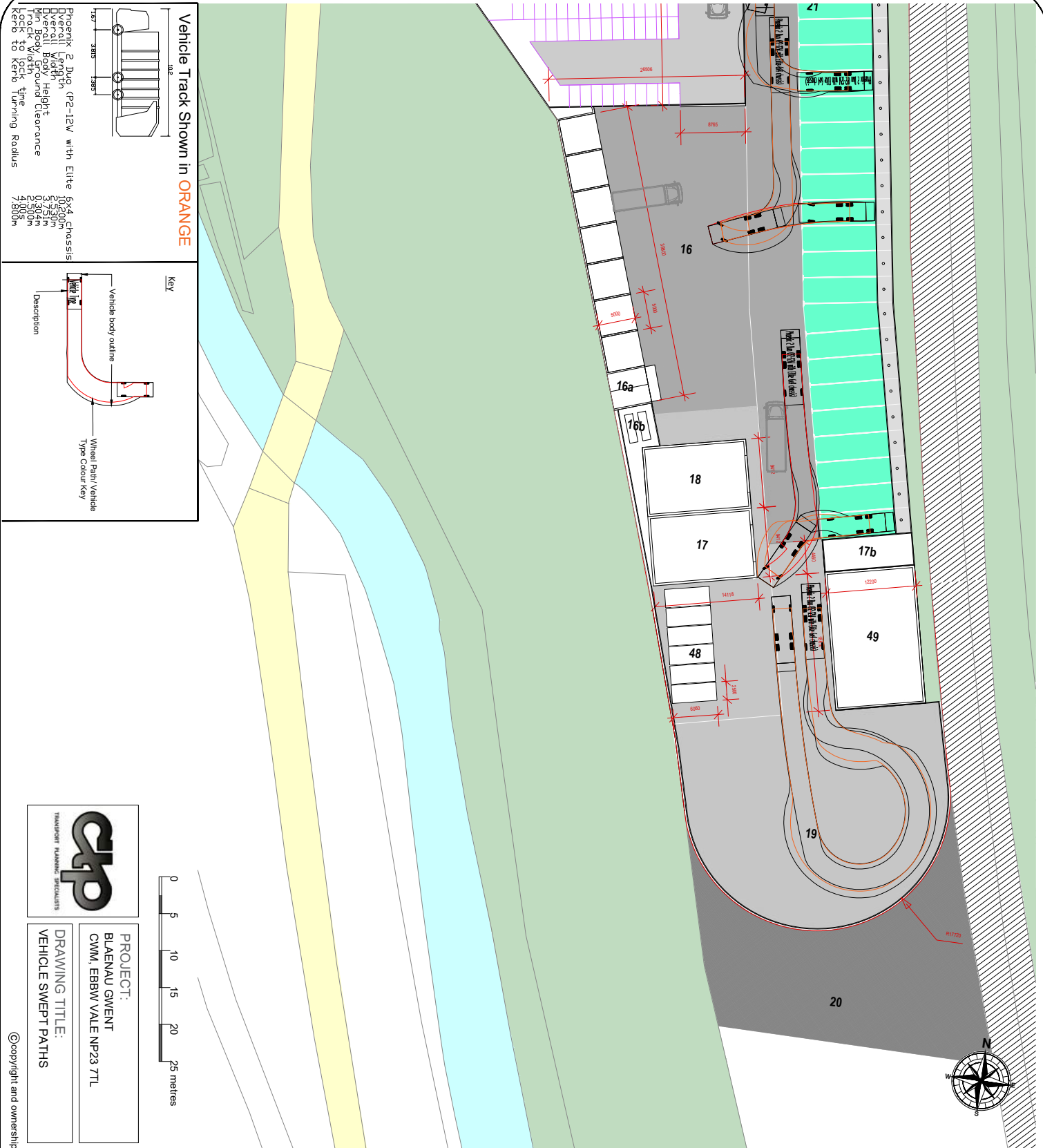

SCHEDULE OF ACCOMMODATION:

- 1 Welfare facility (139 sq m)
- 3 Archives (151sq m)
- 4 Catering / Cleaning Storage (1119sq m)
- 5 DLO workshop / welfare / office (145sq m)
- 6 Main store (loading system) (600 sq m)
- 7 Garage repair facility (1383 sq m inc HGV Bay)
- 7a HGV 'drive through' area incorporated in 7)
- 8 Fuel internal parking area (1672 sq m)
- 8a Welfare / offices
- 8b Internal open storage
- 9 Possible splinker / external plant area / Battery Store (131 sq m)
- 10 External vehicle wash down ramp (facility to clean underside) - enclosed spray housing (120 sq m approx)
- 11 Service vehicle park area
- 12 Protection area to avoid clashes with building
- 13 Fuel area including various fuel types / internal card reader system, CCTV
- 14 Vehicle wash down area with raised area for cleaning roof - enclosed spray housing (1174 sq m) 15 x 10m platform inc raised area and steps
- 15 External storage and racking if required (purple dotted lines indicate storage rack if required)
- 16 Building material hold up zone inc bags and vehicle access area (5 x 5m open bays) (900 sq m)
- 16a Terrace warm store
- 16b Gas fuel for forklifts store
- 17 Main sewer store (130 sq m)
- 17a External sewer store (54 sq m)
- 18 DLO store inc glass racks (130 sq m)
- 19 Potential burning area if required
- 20 Potential future
- 21 Recycling vehicle bays 21no (10 x 3.5m bay) electric hook up
- 22 Cold hose / refuse collection bays 13no (10 x 3.5m bay) electric hook up
- 22A 1hr bus bays 6no (7 x 3m bay) electric hook up
- 24 7.5 vehicle bays (6 x 3m bay) electric hook up
- 25 2L single vans 42no (3 x 3m bay) electric hook up
- 26 Small vans 42no (4.8 x 2.2m bay) electric hook up
- 27 Potential alternative / carriage store / release areas / open water (1622 sq m)
- 28 Existing mine shaft (3rd edition)
- 29 Existing mine shaft with Colliery Winding Wheel and brick wall / vent duct over shaft
- 30 Ore/rag/repair facility entrance external bays / vehicle waiting
- 32 General parking / waiting
- 32a General large vehicle parking / waiting
- 32b Existing cycle route outside boundary
- 34 Existing over outside boundary
- 35 Near crossing point
- 35a Staff parking (electric charging zone) 50 spaces
- 37 Staff / visitors parking / cycle store / accessible parking 67 spaces (1no electric charged access bay)
- 38 General Depot main office (675 sq m)
- 39 Future Development 'P01' / Expansion (2947 sq m) Potential Contractors Construction Compound during Contract
- 40 Central Depot main entrance (access control)
- 41 Main highway outside site boundary
- 42 Access roundabout
- 43 Railway
- 44 Existing Central Depot welfare facility (188 sq m)
- 44a Existing Central Depot welfare facility (1388 sq m)
- 44b Existing Central Depot welfare facility (1495 sq m)
- 47 Existing Central Depot internal parking / store facility foot print (1495 sq m)
- 48 Staff Store (210 sq m)
- 50 Existing Central Depot office facility (299 sq m)
- 51 Cycle Compound
- 52 Bins
- 53 Access Control barrier - TAG system

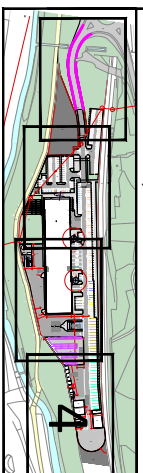

PROJECT:
BLAENAU GWENT
CWM, EBBW VALE NP23 7TL

DRAWING TITLE:
VEHICLE SWEEP PATHS

DRAWN BY:
SC

DATE:
APR 2021

SCALE:
1:500 @ A3

DRAWING No:
170443 / VS01

SHEET:
4 of 4

REVISION:
-

APPENDIX E - BUS SERVICES

APPENDIX F – EXTENT OF PUBLIC HIGHWAY

PROJECT:

TITLE:



© Crown copyright and database rights 2013 Ordnance Survey LA09002L

© Hawlfraint y Goron a hawliau cronfa ddata 2013 Arolwg Ordnans LA09002L



Date : 15/04/2021

Map Reference : SO1804

Scale : 1:5000

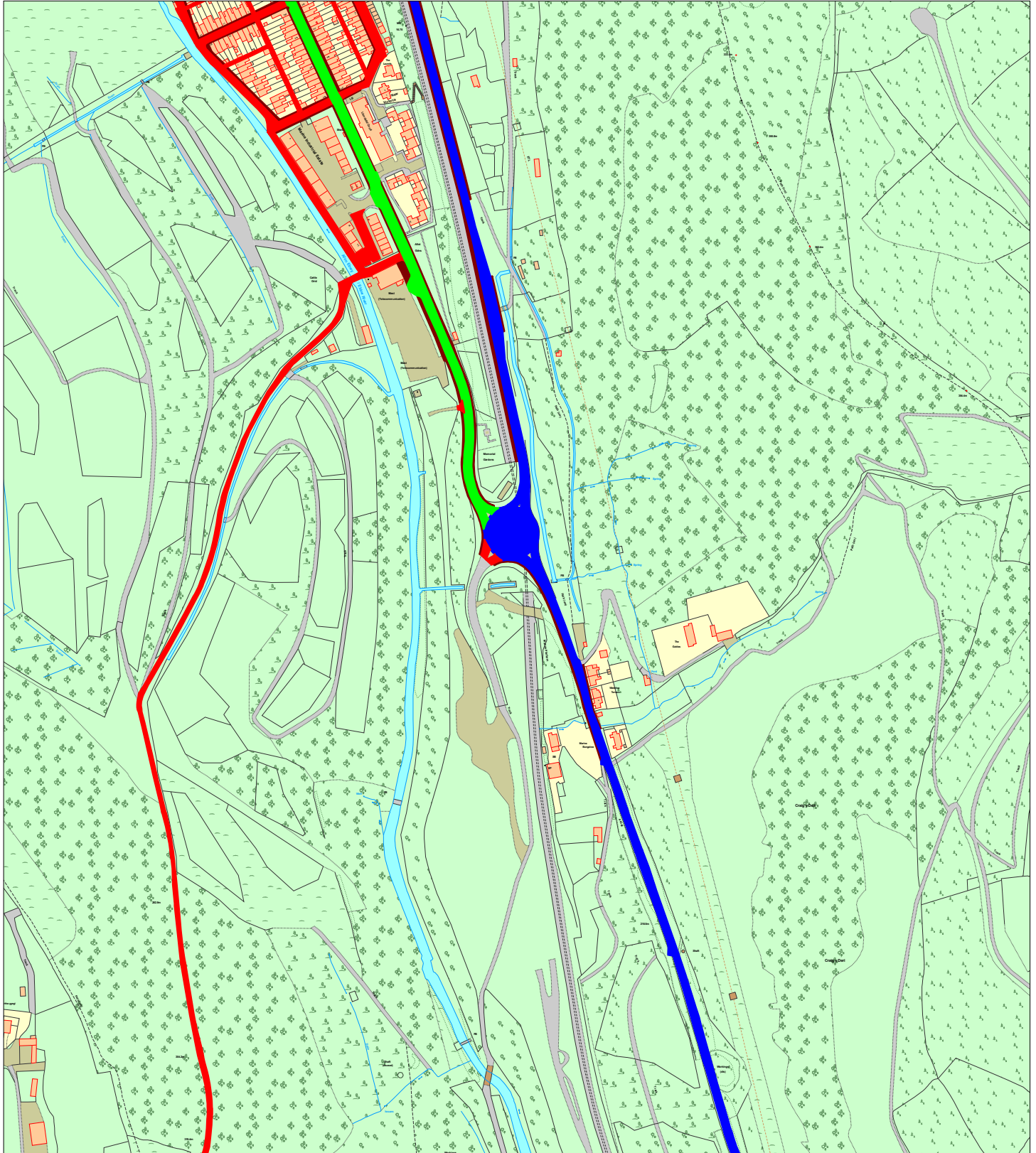

* NB: This reply to your enquiry is believed to be accurate but cannot be guaranteed.

The County Borough Council, as Highway Authority, accept no liability for any loss or damage resulting from this reply, howsoever caused.

APPENDIX G – PERSONAL INJURY DATA



Crash Date:

Friday, July 07, 2017

Time of Crash: 10:27:00 PM

Crash Reference: 2017610025217

Highest Injury Severity:

Slight

Road Number: U0

Number of Casualties: 1

Highway Authority:

Blaenau Gwent

Number of Vehicles: 2

Local Authority:

Blaenau Gwent County Borough

OS Grid Reference: 318734 204661

Weather Description:

Fine without high winds

Road Surface Description:

Dry

Speed Limit:

30

Light Conditions:

Darkness: street lights present and lit

Carriageway Hazards:

None

Junction Detail:

T or staggered junction

Junction Pedestrian Crossing:

No physical crossing facility within 50 metres

Road Type:

Single carriageway

Junction Control:

Give way or uncontrolled



For more information about the data please visit: www.crashmap.co.uk/home/Faq
To subscribe to unlimited reports using CrashMap Pro visit www.crashmap.co.uk/Home/Premium_Services



Vehicles involved

| Vehicle Ref | Vehicle Type | Vehicle Age | Driver Gender | Driver Age Band | Vehicle Manoeuvre | First Point of Impact | Journey Purpose | Hit Object - On Carriageway | Hit Object - Off Carriageway |
|-------------|------------------------------|-------------|---------------|-----------------|--|-----------------------|-----------------|-----------------------------|------------------------------|
| 1 | Car (excluding private hire) | 8 | Female | 21 - 25 | Vehicle is moving off | Offside | Other | None | None |
| 2 | Car (excluding private hire) | 14 | Male | 26 - 35 | Vehicle proceeding normally along the carriageway, not on a bend | Front | Other | None | None |

Casualties

| Vehicle Ref | Casualty Ref | Injury Severity | Casualty Class | Gender | Age Band | Pedestrian Location | Pedestrian Movement |
|-------------|--------------|-----------------|------------------------------|--------|----------|---------------------|---------------------|
| 1 | 1 | Slight | Vehicle or pillion passenger | Female | 16 - 20 | Unknown or other | Unknown or other |

For more information about the data please visit: www.crashmap.co.uk/home/Faq
To subscribe to unlimited reports using CrashMap Pro visit www.crashmap.co.uk/Home/Premium_Services



Crash Date: Tuesday, August 29, 2017

Time of Crash: 3:00:00 PM

Crash Reference: 2017610032017

Highest Injury Severity:

Slight

Road Number: U0

Number of Casualties: 1

Highway Authority:

Blaenau Gwent

Number of Vehicles: 2

Local Authority:

Blaenau Gwent County Borough

OS Grid Reference: 318653 204829

Weather Description:

Fine without high winds

Road Surface Description:

Dry

Speed Limit:

30

Light Conditions:

Daylight: regardless of presence of streetlights

Carriageway Hazards:

None

Junction Detail:

Crossroads

Junction Pedestrian Crossing:

No physical crossing facility within 50 metres

Road Type:

Single carriageway

Junction Control:

Give way or uncontrolled



For more information about the data please visit: www.crashmap.co.uk/home/Faq
To subscribe to unlimited reports using CrashMap Pro visit www.crashmap.co.uk/Home/Premium_Services



Vehicles involved

| Vehicle Ref | Vehicle Type | Vehicle Age | Driver Gender | Driver Age Band | Vehicle Manoeuvre | First Point of Impact | Journey Purpose | Hit Object - On Carriageway | Hit Object - Off Carriageway |
|-------------|------------------------------|-------------|---------------|-----------------|--|-----------------------|-------------------------|-----------------------------|------------------------------|
| 1 | Car (excluding private hire) | 9 | Female | 36 - 45 | Vehicle proceeding normally along the carriageway, not on a bend | Offside | Other | None | None |
| 2 | Car (excluding private hire) | 6 | Female | 16 - 20 | Vehicle proceeding normally along the carriageway, not on a bend | Offside | Journey as part of work | None | None |

Casualties

| Vehicle Ref | Casualty Ref | Injury Severity | Casualty Class | Gender | Age Band | Pedestrian Location | Pedestrian Movement |
|-------------|--------------|-----------------|-----------------|--------|----------|---------------------|---------------------|
| 2 | 1 | Slight | Driver or rider | Female | 16 - 20 | Unknown or other | Unknown or other |

For more information about the data please visit: www.crashmap.co.uk/home/Faq
To subscribe to unlimited reports using CrashMap Pro visit www.crashmap.co.uk/Home/Premium_Services



Crash Date: Thursday, June 07, 2018

Time of Crash: 9:16:00 AM

Crash Reference: 2018610028018

Highest Injury Severity: Slight

Road Number: A4046

Number of Casualties: 1

Highway Authority: Blaenau Gwent

Number of Vehicles: 2

Local Authority: Blaenau Gwent County Borough

OS Grid Reference: 318874 204460

Weather Description: Fine without high winds

Road Surface Description: Dry

Speed Limit: 60

Light Conditions: Daylight: regardless of presence of streetlights

Carriageway Hazards: None

Junction Detail: Not at or within 20 metres of junction

Junction Pedestrian Crossing: No physical crossing facility within 50 metres

Road Type: Single carriageway

Junction Control: Not Applicable

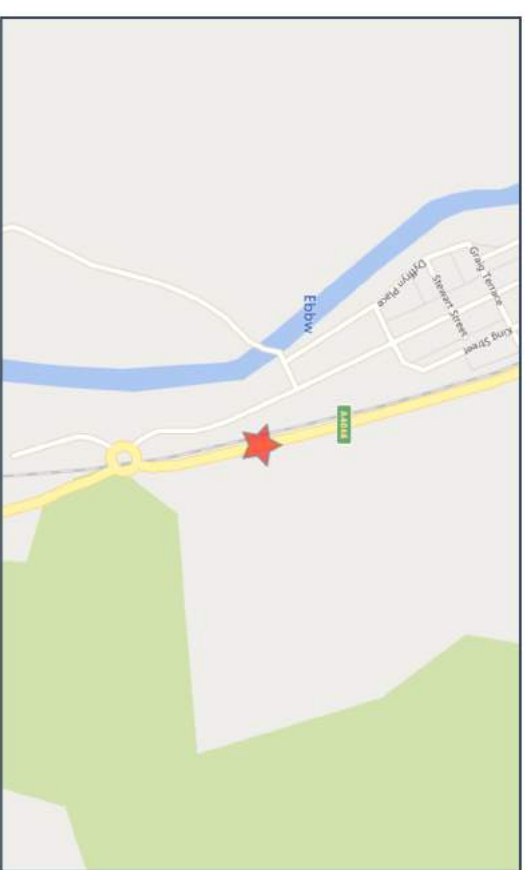

For more information about the data please visit: www.crashmap.co.uk/home/Faq
To subscribe to unlimited reports using CrashMap Pro visit www.crashmap.co.uk/Home/Premium_Services



Vehicles involved

| Vehicle Ref | Vehicle Type | Vehicle Age | Driver Gender | Driver Age Band | Vehicle Manoeuvre | First Point of Impact | Journey Purpose | Hit Object - On Carriageway | Hit Object - Off Carriageway |
|-------------|------------------------------|-------------|---------------|-----------------|--|-----------------------|-----------------|-----------------------------|------------------------------|
| 1 | Car (excluding private hire) | -1 | Male | 21 - 25 | Vehicle proceeding normally along the carriageway, not on a bend | Front | Other | None | None |
| 2 | Car (excluding private hire) | 12 | Female | 21 - 25 | Vehicle is slowing down or stopping | Back | Other | None | None |

Casualties

| Vehicle Ref | Casualty Ref | Injury Severity | Casualty Class | Gender | Age Band | Pedestrian Location | Pedestrian Movement |
|-------------|--------------|-----------------|-----------------|--------|----------|---------------------|---------------------|
| 2 | 1 | Slight | Driver or rider | Female | 21 - 25 | Unknown or other | Unknown or other |

For more information about the data please visit: www.crashmap.co.uk/home/Faq
To subscribe to unlimited reports using CrashMap Pro visit www.crashmap.co.uk/Home/Premium_Services



Crash Date: Saturday, July 06, 2019

Time of Crash: 1:23:00 PM

Crash Reference: 2019610029619

Highest Injury Severity:

Fatal

Road Number: A4046

Number of Casualties: 3

Highway Authority:

Blaenau Gwent

Number of Vehicles: 3

Local Authority:

Blaenau Gwent County Borough

OS Grid Reference: 318791 204796

Weather Description:

Fire without high winds

Road Surface Description:

Dry

Speed Limit:

60

Light Conditions:

Daylight: regardless of presence of streetlights

Carriageway Hazards:

None

Junction Detail:

Not at or within 20 metres of junction

Junction Pedestrian Crossing:

No physical crossing facility within 50 metres

Road Type:

Single carriageway

Junction Control:

Not Applicable



For more information about the data please visit: www.crashmap.co.uk/home/Faq
To subscribe to unlimited reports using CrashMap Pro visit www.crashmap.co.uk/Home/Premium_Services



Vehicles involved

| Vehicle Ref | Vehicle Type | Vehicle Age | Driver Gender | Driver Age Band | Vehicle Manoeuvre | First Point of Impact | Journey Purpose | Hit Object - On Carriageway | Hit Object - Off Carriageway |
|-------------|------------------------------|-------------|---------------|-----------------|--|-----------------------|-----------------|-----------------------------|-----------------------------------|
| 1 | Car (excluding private hire) | 5 | Male | 46 - 55 | Vehicle proceeding normally along the carriageway, not on a bend | Front | Other | None | None |
| 2 | Car (excluding private hire) | 6 | Male | 66 - 75 | Vehicle proceeding normally along the carriageway, not on a bend | Offside | Other | None | None |
| 3 | Car (excluding private hire) | 6 | Male | 66 - 75 | Vehicle proceeding normally along the carriageway, not on a bend | Front | Other | None | Nearside or offside crash barrier |

Casualties

| Vehicle Ref | Casualty Ref | Injury Severity | Casualty Class | Gender | Age Band | Pedestrian Location | Pedestrian Movement |
|-------------|--------------|-----------------|------------------------------|--------|----------|---------------------|---------------------|
| 2 | 1 | Slight | Driver or rider | Male | 66 - 75 | Unknown or other | Unknown or other |
| 3 | 2 | Serious | Driver or rider | Male | 66 - 75 | Unknown or other | Unknown or other |
| 3 | 3 | Fatal | Vehicle or pillion passenger | Female | 56 - 65 | Unknown or other | Unknown or other |

For more information about the data please visit: www.crashmap.co.uk/home/Faq
To subscribe to unlimited reports using CrashMap Pro visit www.crashmap.co.uk/Home/Premium_Services